



# Pop-Up Card

## ASSEMBLY INSTRUCTIONS



### GETTING STARTED

#### MATERIALS:

- Scissors
- Glue
- Ruler
- Butter knife
- 2 or more sheets of heavyweight paper

- 1 Print out pop-up pieces (page 3) and inside of card (page 4) and allow to dry. (Make sure to get a parent or guardian's permission before printing.)

- 2 Put page 4 back into the paper tray so that you can print page 5 on the back side. (For most printers, you will insert the printed page back into the paper tray exactly as it came out.) You may want to do a draft print first.

- 3 Score all pieces: Using a ruler as a guide, run the back side of a butter knife firmly along all dashed lines.

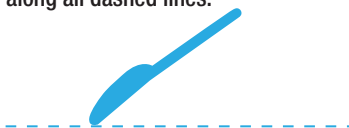

- 4 Using scissors, carefully cut along solid black lines of pop-up pieces on page 3.



### ASSEMBLE YOUR POP-UP CARD

- 5 Fold in the tabs on piece "A". Apply glue to one tab and press the other tab down on top to make a band.

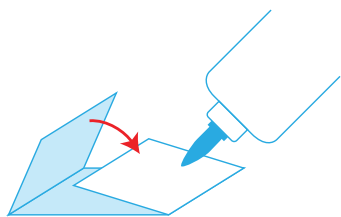

- 6 Slide piece "B" into the band you just made. Apply glue to the back of the end of piece "B" (the end opposite to Perry the Platypus), then fold over and glue behind Perry.

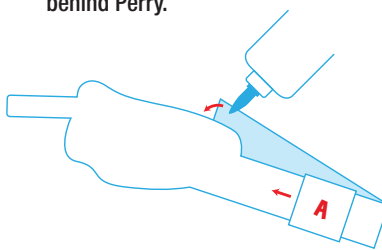

- 7 Apply glue to the front of piece "A" and adhere to the back of piece "C" (just below the big, blue gift box) so that only the "pull me" tab is showing.

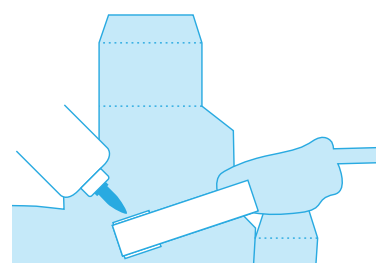

- 8 Apply glue to all of the tabs on piece "C."

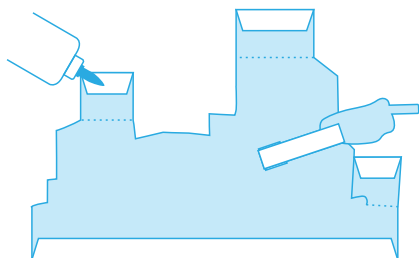

- 9 Align and adhere piece "C" tabs to placement lines on page 2 (inside of card).

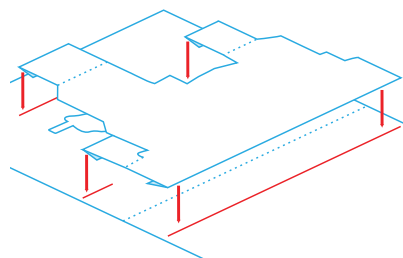

Watch Phineas and Ferb on Disney Channel!

[DisneyChannel.com/Holiday](http://DisneyChannel.com/Holiday)

©Disney

## ASSEMBLY CONTINUED

- 10** Glue the ends of piece “D” and piece “E” together to create a 90-degree angle.

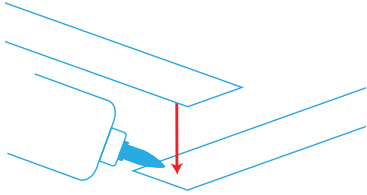

- 11** Use pieces “D” and “E” to create an accordion-shaped spring. Fold one piece over the other, starting with the bottom piece. Fold the last end over and glue to top of spring.

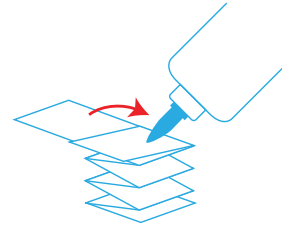

- 12** Glue one end of your spring to the back of piece “F.”

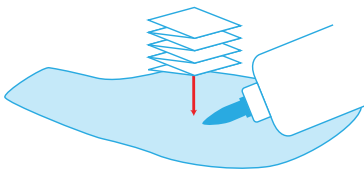

- 13** Adhere the other end of your spring to the upper, right-hand corner of page 2.

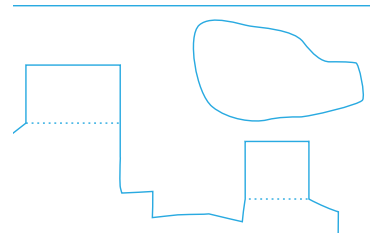

- 14** You're done! Now you can give to someone special.



**Watch Phineas and Ferb on Disney Channel!**

[DisneyChannel.com/Holiday](http://DisneyChannel.com/Holiday)

©Disney

POP-UP PIECES



D

E

F



B

--	--	--

A

C

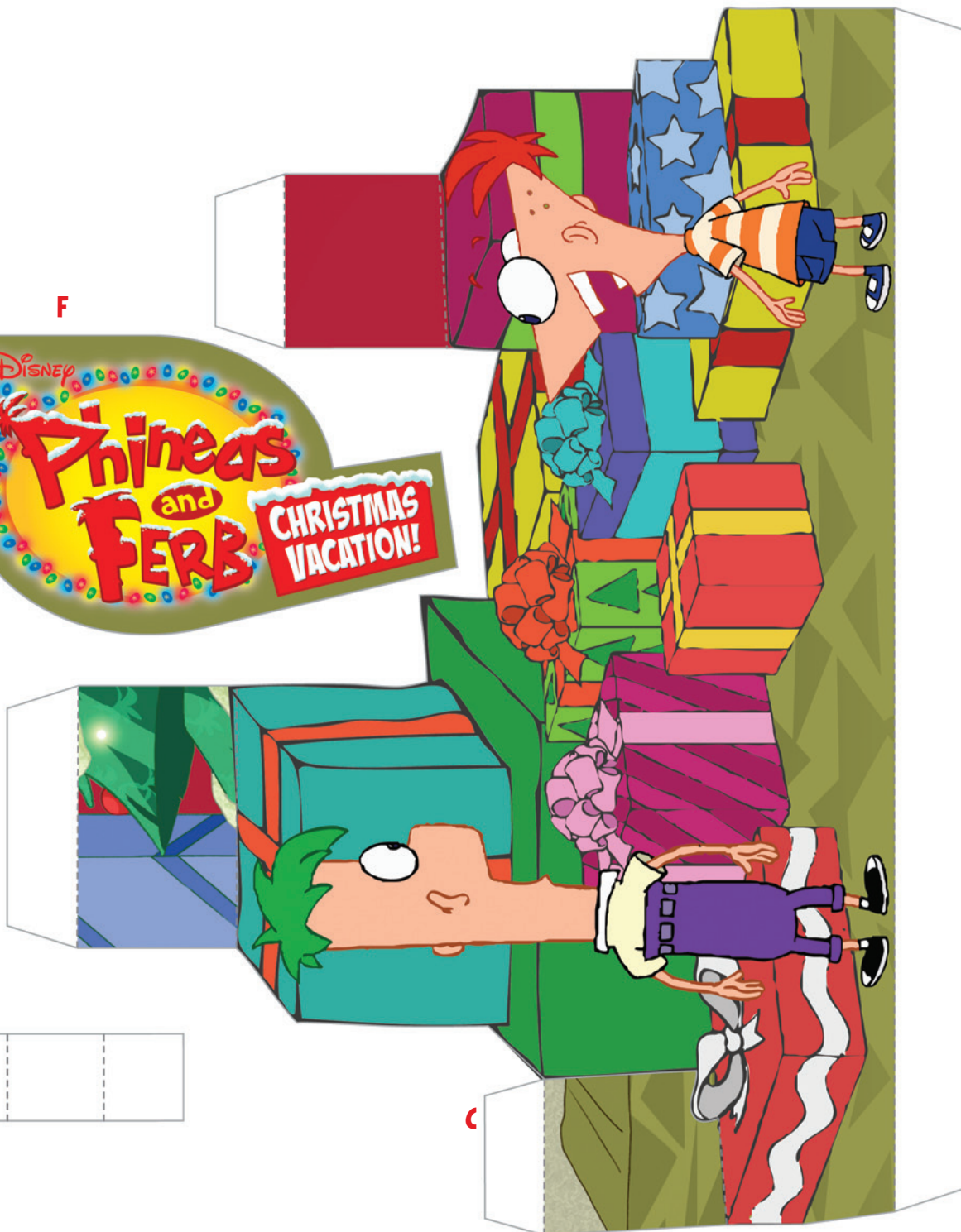

Watch Phineas and Ferb on Disney Channel!

[DisneyChannel.com/Holiday](http://DisneyChannel.com/Holiday)

©Disney





